

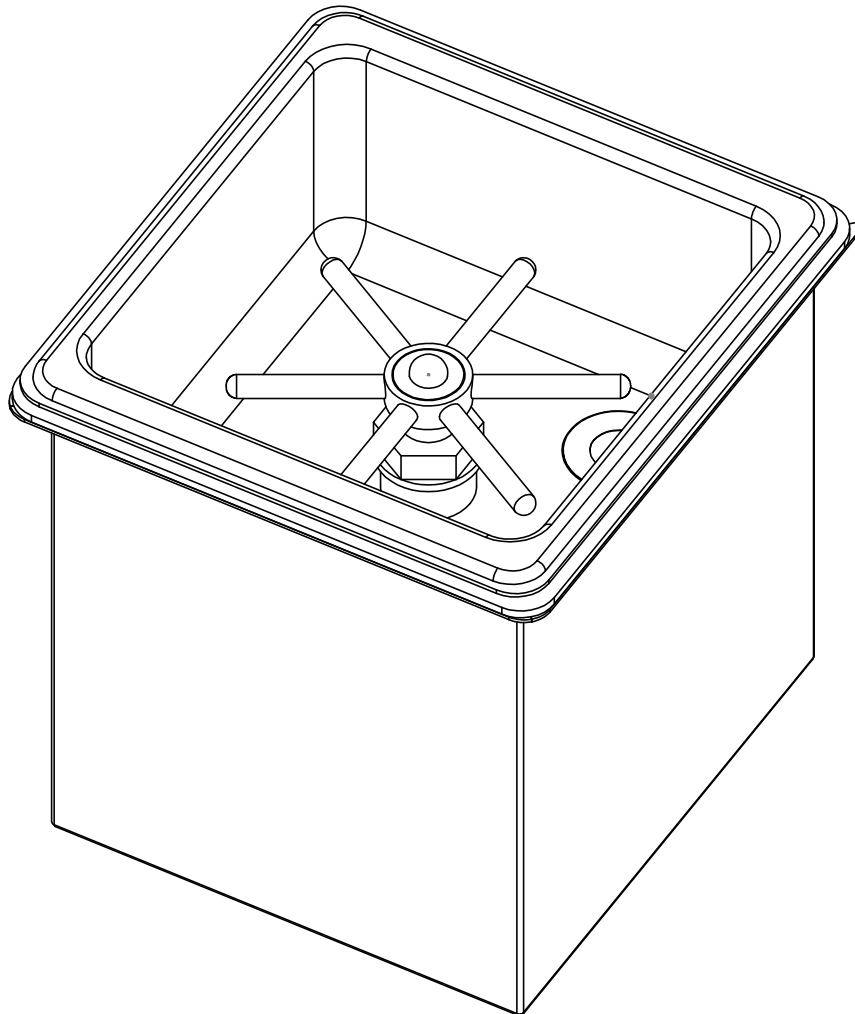

Foldable Bar Glass Rinser System Setup Guide



- **Read all the instructions before installing.**
- **Remove all packing materials before you start.**
- **This installation requires basic mechanical skills.**
- **Proper installation is the responsibility of the installer**
- **Product failure due to improper installation is not covered under the warranty**
- **Keep this instruction manual.**

Required tools

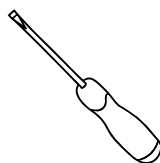

Flat Screwdriver



Crescent Wrench

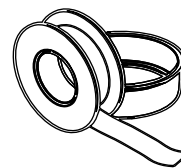

Teflon Tape

Attention

All throughout this document you'll simultaneously see imagery for both the Distressed Bar and the Professional Bars respectively. All images showing either bar will be displayed in the format below:

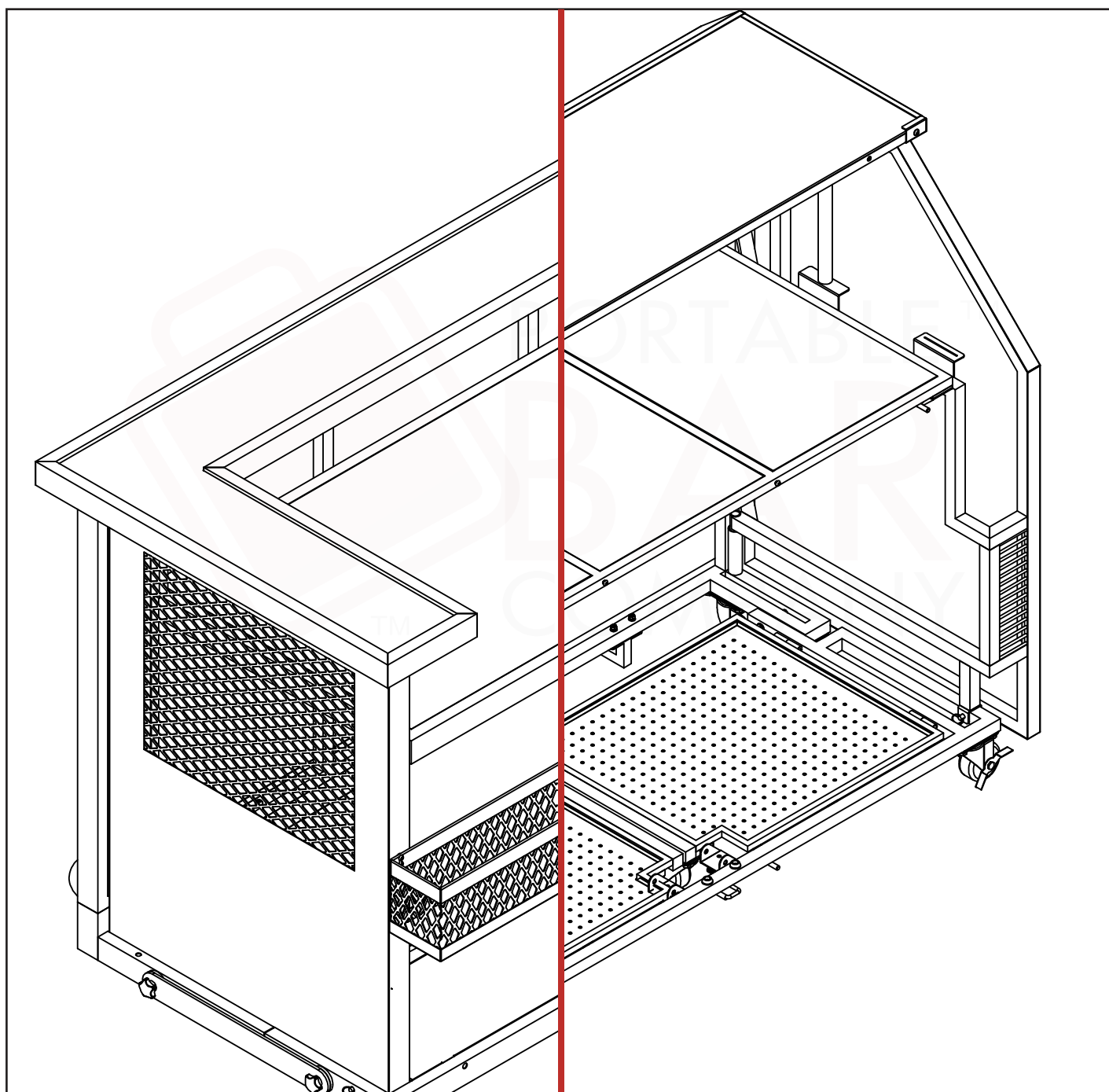

Note: Even though the Distressed Bar is shown on all images, all steps would apply the same to the Stainless Steel Heavy Duty Fold & Roll Bar.

Glass Rinser
QTY: 1

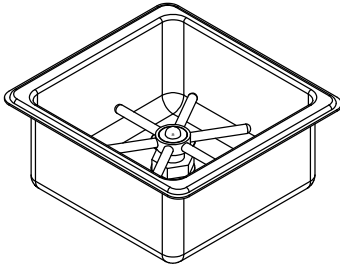

Rinser Gasket
QTY: 1

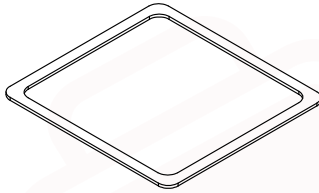

Water tank and gray water tank
QTY: 2

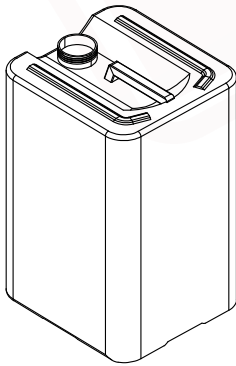

Braided Hose
QTY: 1ea

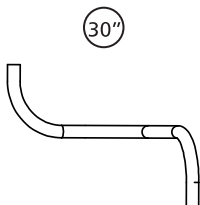

Rinser Base
QTY: 1

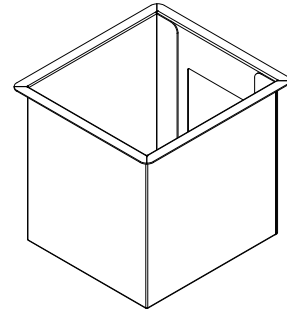

Pump
QTY: 1

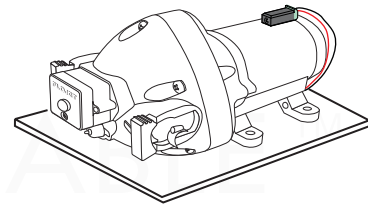

Pump adapters
QTY: 1ea

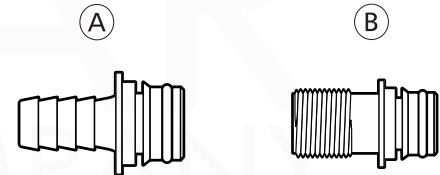

Clear plastic hose and clamp
QTY: 1ea

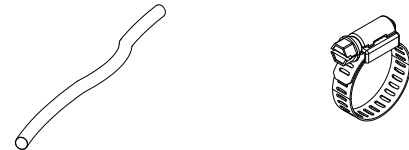

Surge protector and Power supply
QTY: 1ea

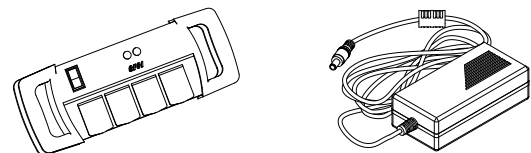

Note: Parts are not to scale.

STEP 1: Install adapter (A) to the inlet port of the pump and adapter (B) to the discharge port; first push the adapter into the pump, then fix the adapter in place pushing in the mounted blue clamps. Follow the diagrams below:

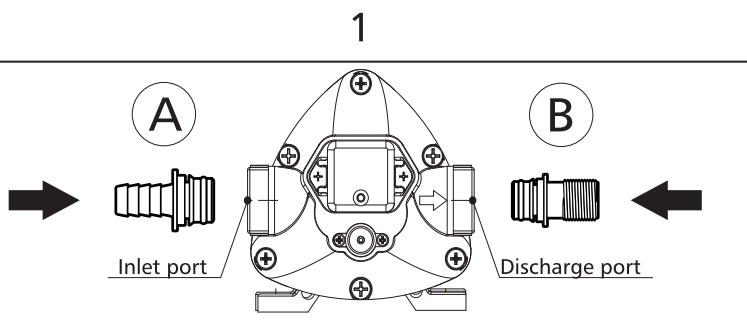

Figure 1

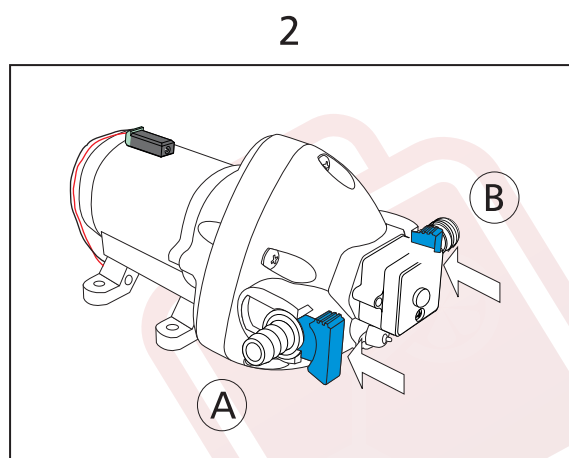

Figure 2

STEP 2: Slide in ice bins and position them as shown below:

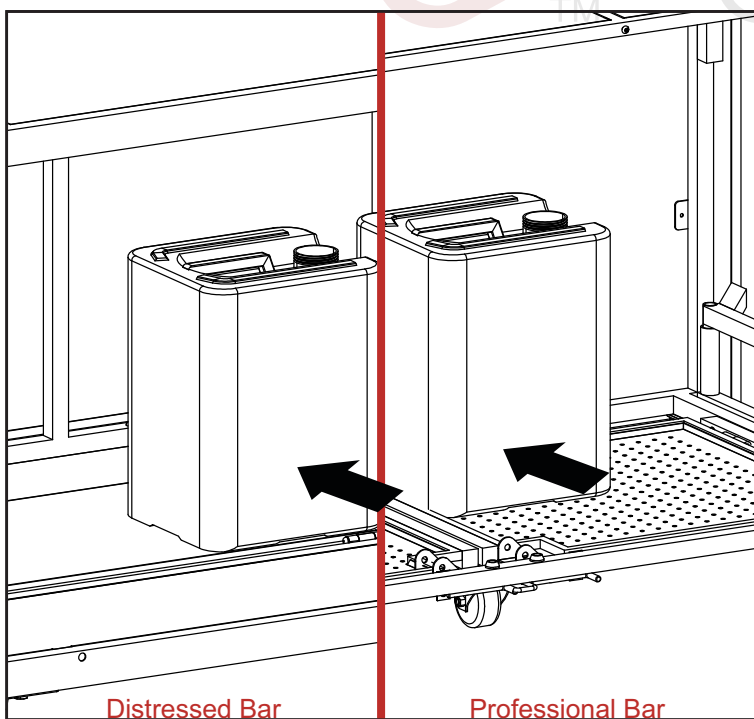

Figure 3

STEP 3: Detach rinser from its base.

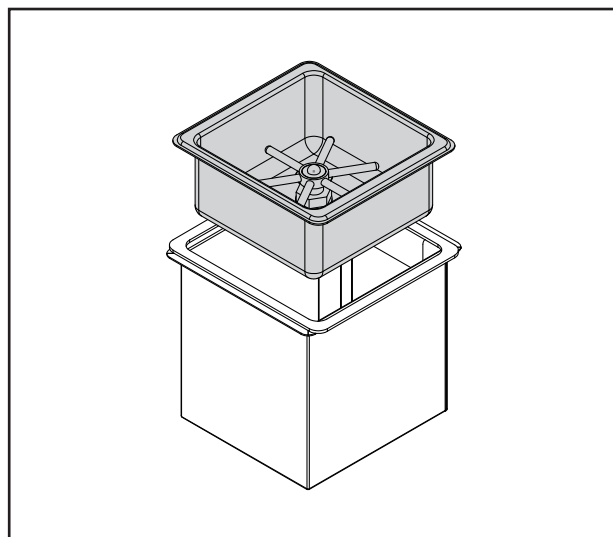

Figure 4

STEP 4: Install the 7/8" clear plastic hose using provided hose clamp. Then proceed to install the braided hose:

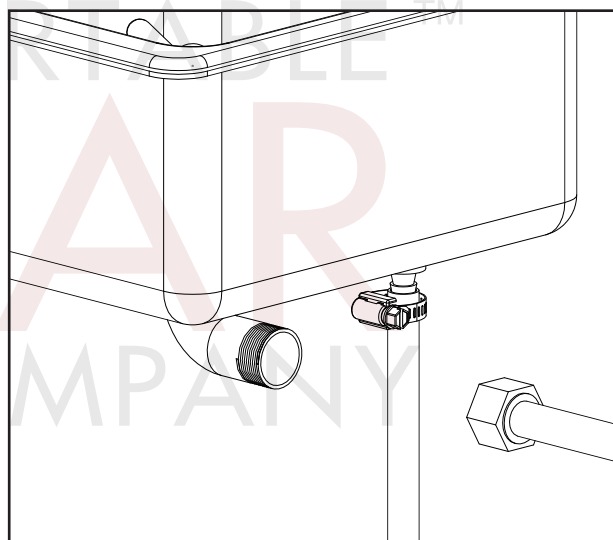

Figure 5

STEP 5: Put rinser back in place making sure both hoses pass through the base back opening, as shown below:

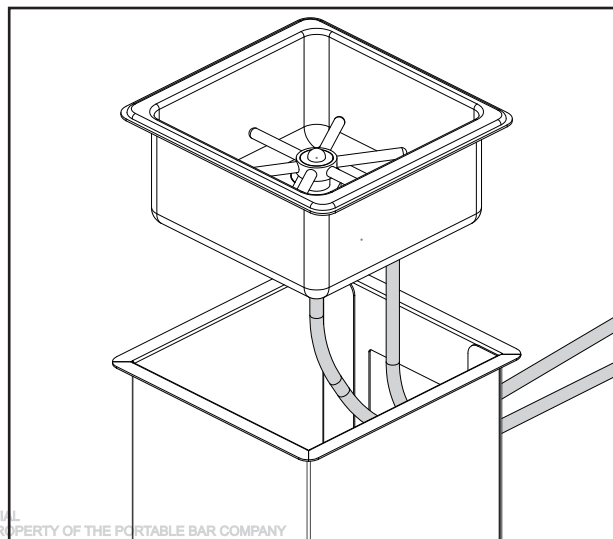

Figure 6

STEP 6: Set Glass Rinser on working surface passing both hoses behind the working surface into the lower shelf. Insert the clear plastic hose in the Gray Water tank's opening, as shown below:

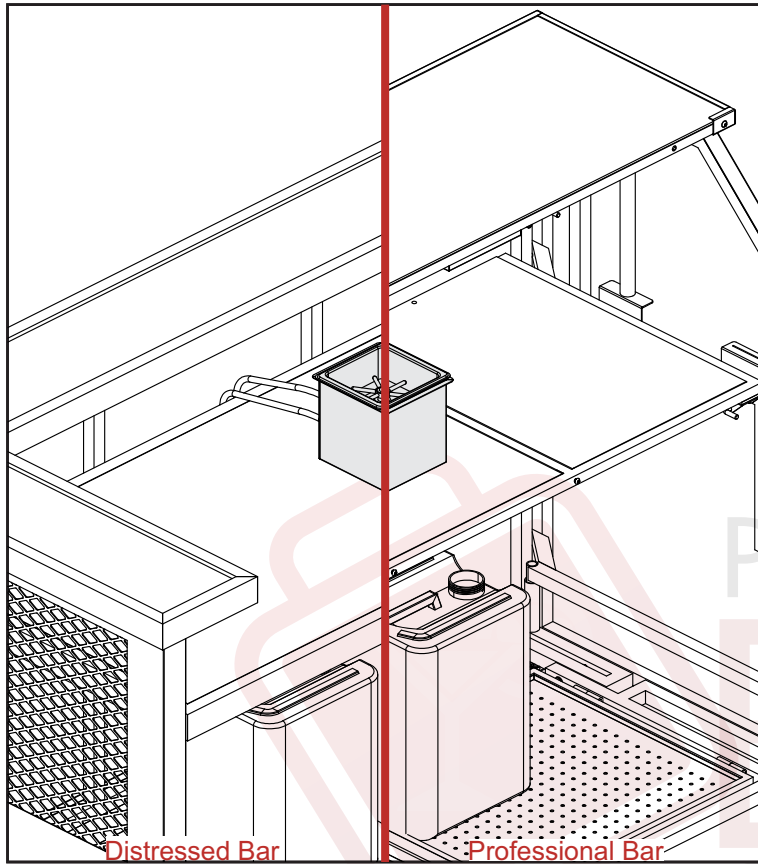

Figure 7

STEP 7: Install the short clear plastic hose in the pump's inlet port using a hose clamp. Then take the braided hose coming from the glass rinser and plug it into the pump's Discharge port.

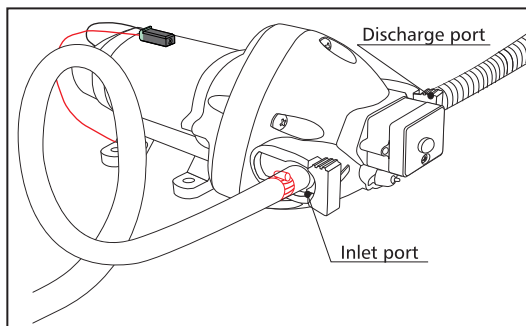

Figure 8

STEP 8: Rest pump on the Clear Water Tank and insert the inlet hose into the tank's opening.

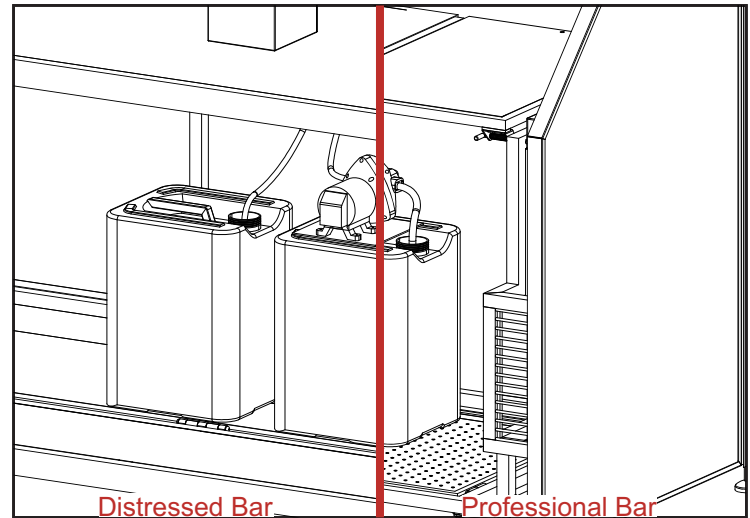

Figure 9

STEP 9: Stick surge protector to the back frame of your Distressed Bar or rest it on top of the small shelf of your Professional Bar, as shown. Plug the pump's power supply to the surge protector and run the power adapter cable from behind the working surface and plug it into the pump's power plug.

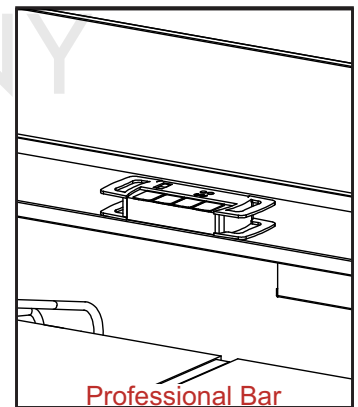
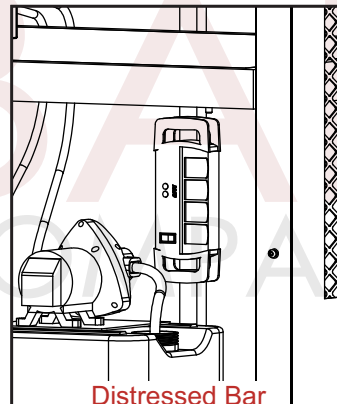

Figure 10

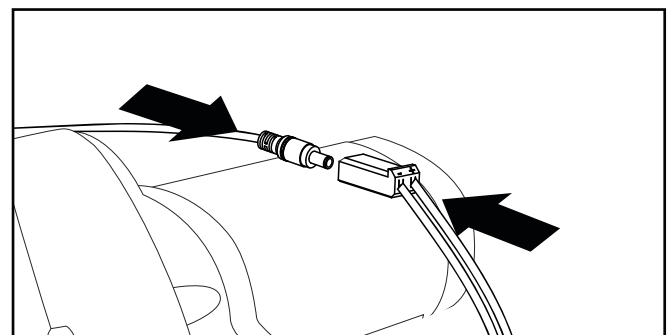

Figure 11

**Do not plug the power supply to the wall.
Pump will activate when plugged in.
There is no on/off switch.**

Before turning the system on

- Make sure all the fittings, hoses and cables are properly plugged and/or sealed.
- Double read this guide if necessary.
- Read the maintenance and care guide as well as the pump manufacturer's guide.

Operating the system

To turn it on

1. Fill the clean water tank.
2. Connect the surge protector to a wall plug.
3. Press down the glass rinser using a glass until you see water come out.

To turn it off

1. Turn off surge protector or disconnect it from wall plug.
2. Press down the glass rinser using a glass until all water inside the hose comes out.

Recommendations

- Always keep water inside the the clean water tank, this is critical for the system to work properly.
- The hoses could keep water inside of them after every use.
- The pump is capable of running dry for a couple minutes. Serious damage could occur if it runs dry for long periods of time.
- When disassembling the system there will always be water left in the hoses. Have a towel handy as you are taking apart.

CAUTION:The Portable Bar Company IS NOT liable for any injury caused by misuse, spills, accidents nor by improper installations, alterations, or repairs. Please use the system with caution only.

Room Temperature Sink System Glass Rinser Add-on

Glass Rinser
QTY: 1

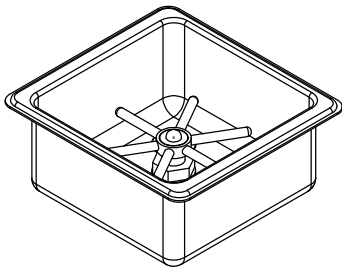

Gasket
QTY: 1

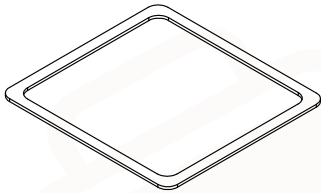

Gray Water Tank
QTY: 1

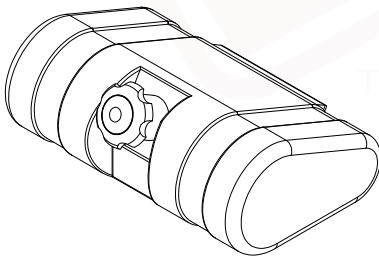

Splitter
QTY: 1

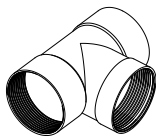

Rinser Base
QTY: 1

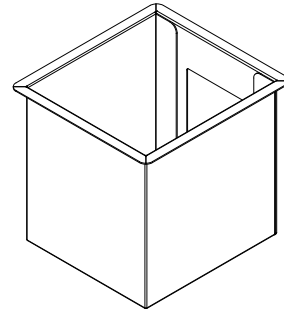

Braided Hose
QTY: 1

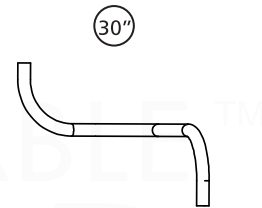

Clear Plastic Hose and Clamp
QTY: 1ea



Coupler
QTY: 2



Note: Parts are not to scale.

Cold Sink System Rinser Add-on

Note: Start installation by following the sink system setup guide for your respective Bar. Return to this guide when indicated by the guide.

STEP 1: Connect both couplers and pump adapter to splitter, as shown below. Use as much teflon tape as needed.

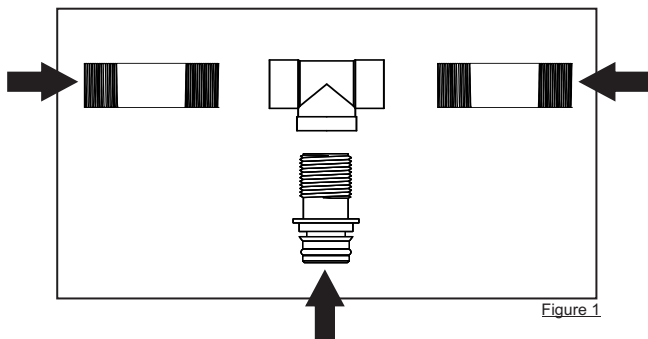

Figure 1

STEP 2: Connect both; the provided braided hose and the included one from your Flash Bar Sink System to the splitter. Plug splitter into the discharge port of your Sink System pump.

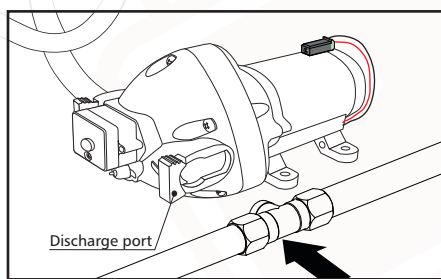

Figure 2

STEP 3: Remove rinser from its base.

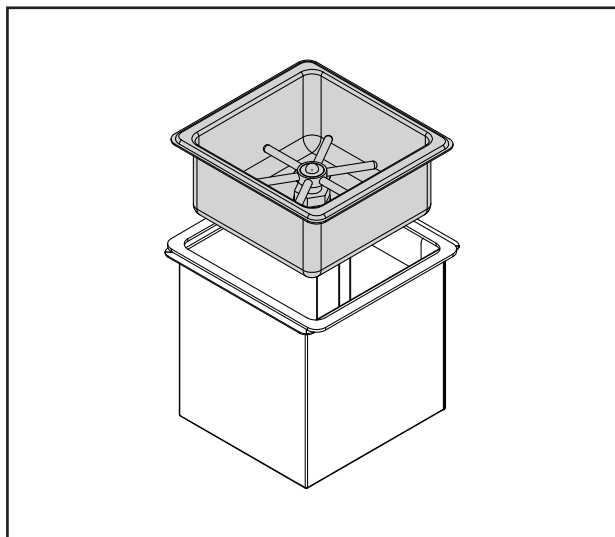

Figure 3

STEP 4: Install clear plastic hose using provided hose clamp. Make sure to tighten well. Then install braided hose connected to pump splitter. Use as much teflon tape as needed.

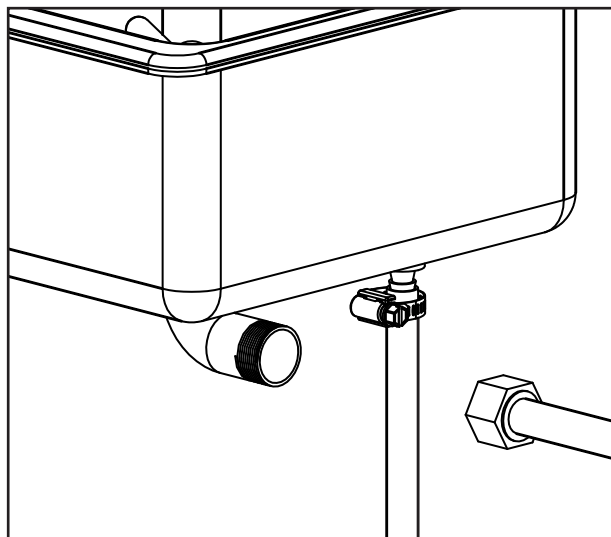

Figure 4

STEP 5: Place rinser on top of its base. Make sure that both hoses pass through the base back opening.

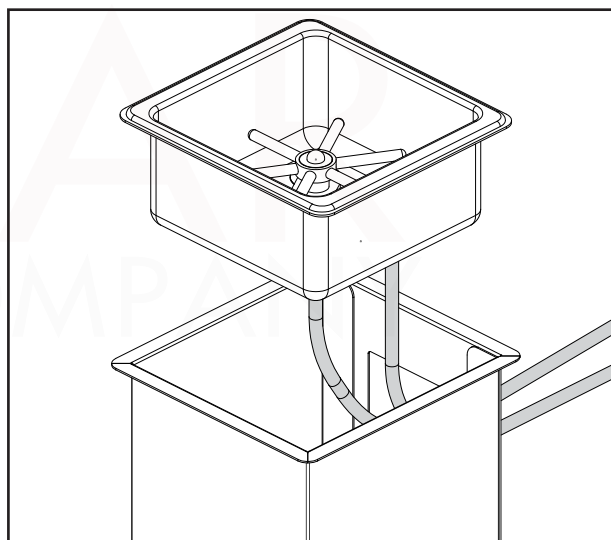

Figure 5

STEP 6: Pass both hoses behind the working surface.

STEP 7: Plug both braided hoses - the one coming from the faucet and the one coming from the rinser - to the pump's splitter.

STEP 8: Slide in clean and gray water tanks and position them as shown below. Rest pump on the clean water tank.

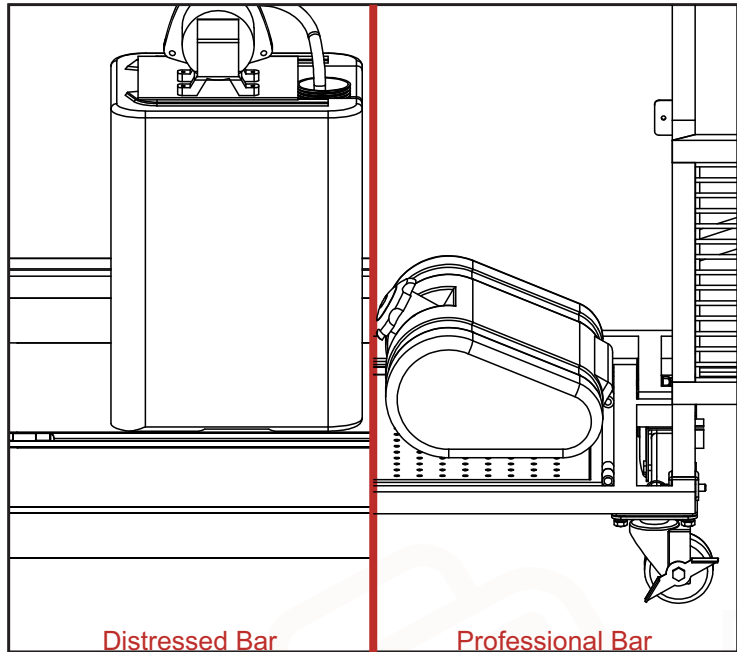

Figure 6

STEP 9: Insert clear plastic hose in gray water tank, as shown.

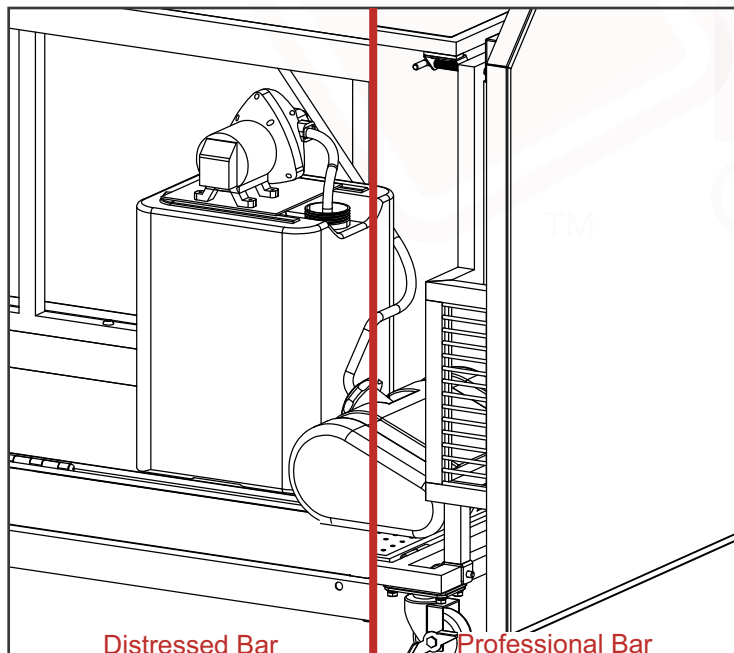

Figure 7

Note: Please return to the respective sink system guide of your bar to complete the installation.

Distressed Bar: Page 6 STEP 9

Professional Bar: Page 5 STEP 10

Operating your rinser

To turn it on

1. Fill the clean water tank.
2. Turn on faucet.
3. Power on system by turning the GFCI strip power switch to the on position.
4. Press down on rinser using a glass.
5. Wait for water to come out of both faucet and rinser.
6. Turn faucet off and rinser off. You may start using your system as usual.

To turn it off

1. Turn faucet on.
2. Press down rinser using a glass.
2. Power off system by turning the GFCI switch to the off position.
3. Keep pressing down on rinser until no water comes out.

HOT & COLD Sink System Glass Rinser Add-on

Glass Rinser

QTY: 1

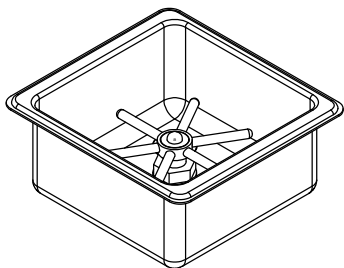
**Gasket**

QTY: 1

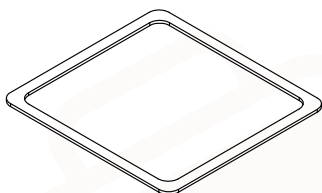
**Gray Water Tank**

QTY: 1

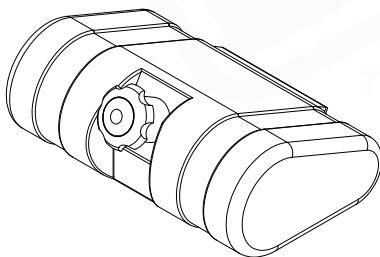
**Splitter**

QTY: 1

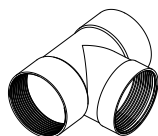
**Rinser Base**

QTY: 1

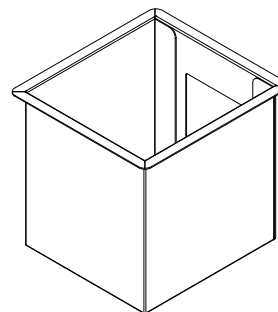
**Braided Hose**

QTY: 1

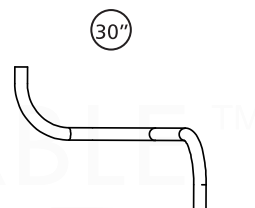
**Clear Plastic Hose and Clamp**

QTY: 1ea

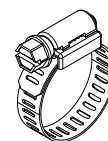
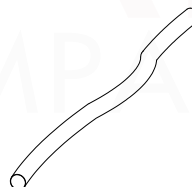
**Coupler**

QTY: 2



Note: Parts are not to scale.

Cold Sink System Rinsers Add-on

Note: Start installation by following the sink system setup guide for your respective Bar. Return to this guide when indicated by the guide.

STEP 1: Connect both couplers to splitter, as shown below. Use as much teflon tape as needed.

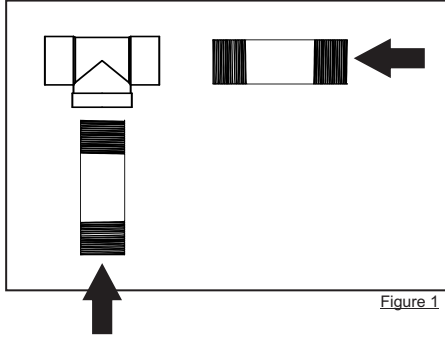

Figure 1

STEP 2: Remove rinsers from its base.

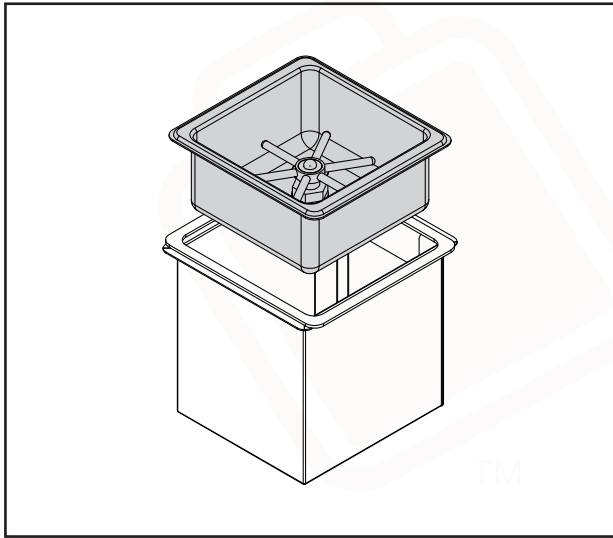

Figure 3

STEP 4: Install clear plastic hose using provided hose clamp. Make sure to tighten well. Then install braided hose connected to pump splitter. Use as much teflon tape as needed.

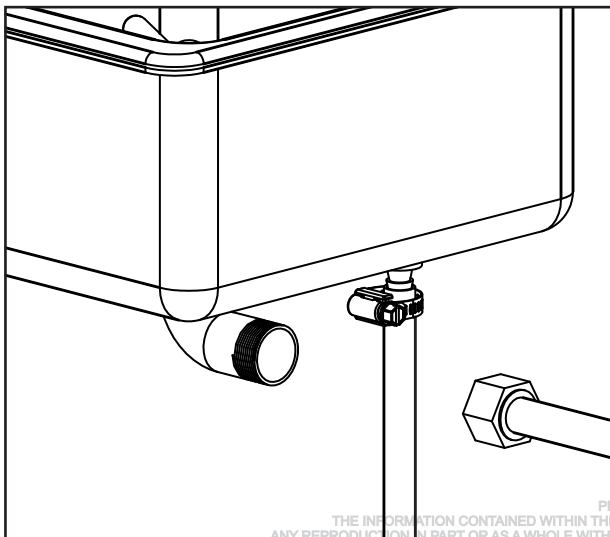

Figure 4

STEP 5: Place rinsers on top of its base. Make sure that both hoses pass through the base back opening.

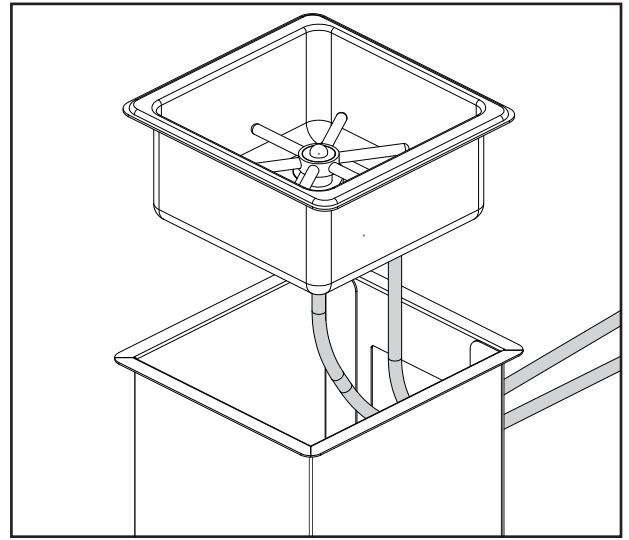
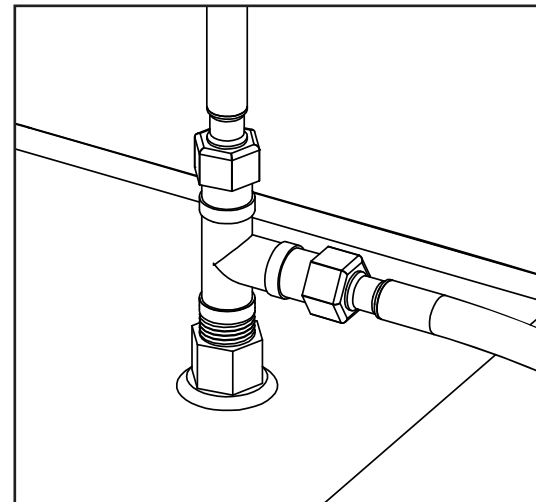
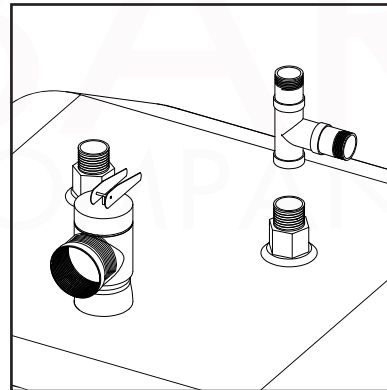

Figure 5

STEP 6: Pass both hoses behind the working surface.

STEP 7: Connect splitter to the inlet port Water heater. Proceed then to plug the braided hose coming from the rinsers and one of the plugs coming from the pump, as shown:



STEP 8: Connect braided hose coming from the hot side of the faucet to the outlet port of the heater to then connect the second hose coming from the pump to the splitter. Make sure all plumbing connections follow the diagram below:

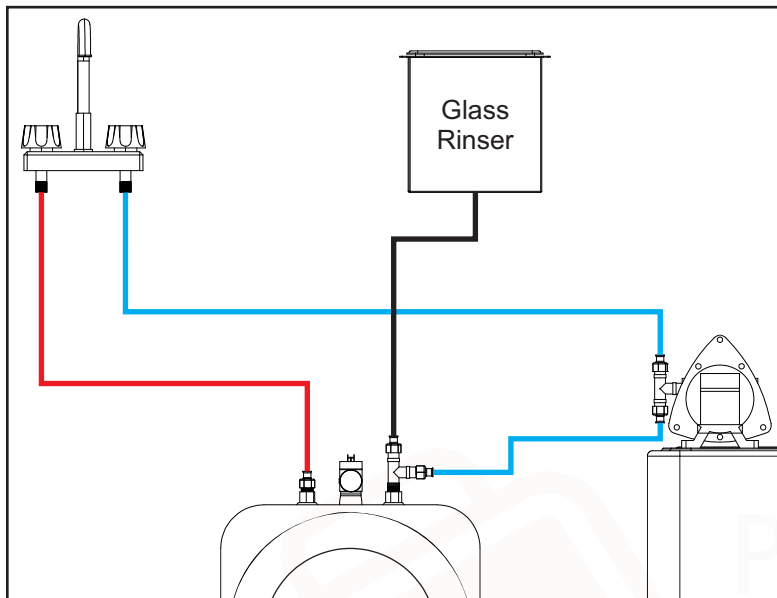

STEP 9: Slide in gray water tank next to the clean water tank and insert clear plastic hose coming from the rinsers, as shown.

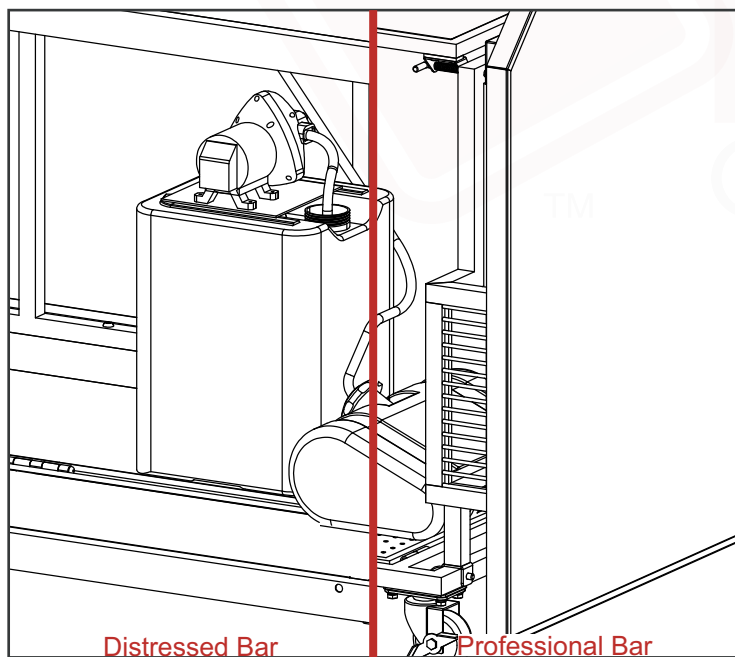

Figure 7

*Note: Please return to the respective sink system guide of your bar to complete the installation.
Distressed Bar/HD Stainless Steel Bar/Professional Bar:
Page 6 STEP 15*

Operating your rinsers

To turn it on

1. Fill the clean water tank.
2. Turn on faucet.
3. Power on system by turning the GFCI strip power switch to the on position.
4. Press down on rinsers using a glass.
5. Wait for water to come out of both faucet and rinsers.
6. Turn faucet off and rinsers off. You may start using your system as usual.

To turn it off

1. Turn faucet on.
2. Press down rinsers using a glass.
2. Power off system by turning the GFCI switch to the off position.
3. Keep pressing down on rinsers until no water comes out.



Contact us

Tel # 877-958-7901

Fax # 866-659-3353

E-mail: info@theportablebarcompany.com

Visit us at

www.theportablebarcompany.com

