



4-BASIN SINK SETUP GUIDE



- **Read all the instructions before installing.**
- **Remove all packing materials before you start.**
- **This installation requires basic mechanical skills.**
- **Proper installation is responsibility of the installer.**
- **Product failure due to improper installation is not covered under the warranty.**
- **Keep this instruction manual.**

Required tools

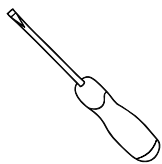

Flat Screwdriver



Pipe Pliers

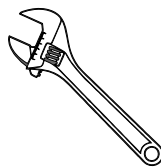

Crescent Wrench

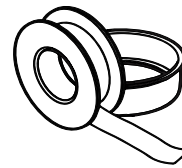

Teflon Tape

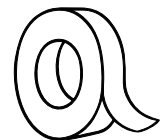

Electrical Tape

4-Basin Sink

QTY: 1

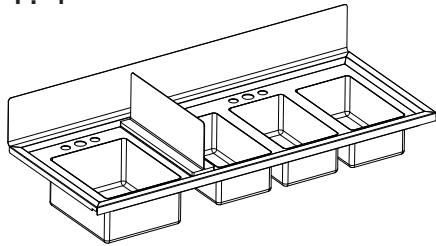

8" Faucet

QTY: 1

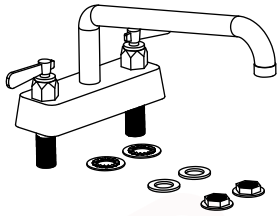

12" Faucet

QTY: 1

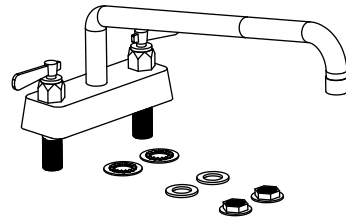

Drain

QTY: 4

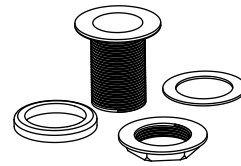

Surge protector and Power adapter

QTY: 1

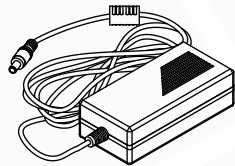
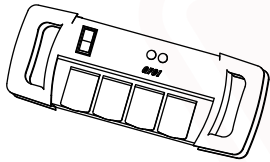

Pump

QTY: 1

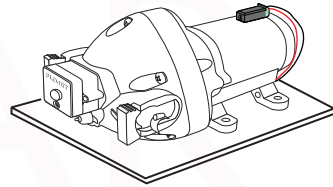

PVC Plumbing

QTY: 1

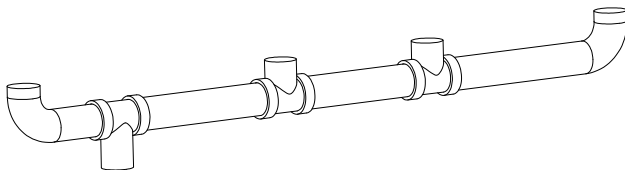

6 gal Tank

QTY: 1

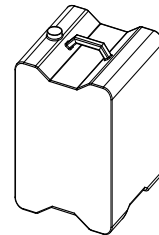

5 gal Tank

QTY: 1

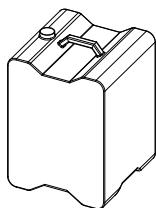

Water Heater

QTY: 1

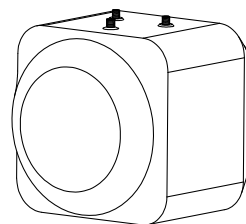

Note: Parts are not to scale.

PROPRIETARY AND CONFIDENTIAL
THE INFORMATION CONTAINED WITHIN THIS DOCUMENT IS THE SOLE PROPERTY OF THE PORTABLE BAR COMPANY
ANY REPRODUCTION IN PART OR AS A WHOLE WITHOUT THE WRITTEN PERMISSION OF THE PORTABLE BAR COMPANY IS PROHIBITED.

Splitter
QTY: 3

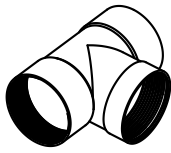

Adapters
QTY: 8

1 x (A)

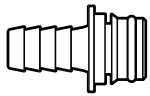

1 x (B)

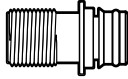

6 x (C)



Couplings
QTY: 2

(D)



12" Braided Hose
QTY: 1

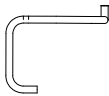

Pressure Relief Valve
QTY: 1

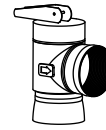

Plastic hose and clamp
QTY: 1 ea

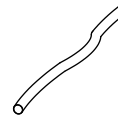

30" Braided Hoses
QTY: 4



Note: Parts are not to scale.



STEP 1: Start by joining the side frame and feet together. Tighten the feet up with thumb screws.

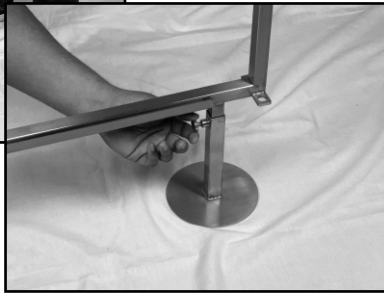

STEP 2: Install foot rail by aligning it with square near the back feet.



STEP 3: Install the lower ACP panel by aligning the four posts located at the sides of the ACP panel with the tabs on the side frames.

STEP 4: Slide in the bottom shelf.





STEP 5: Place the 4-basin sink on a flat surface.

STEP 6: To install the drains; first place the soft seal washer on the inner part of the basin, then put the drainer on top of it.

From the under side of the basin, place the hard seal washer as shown on image #3 and proceed to tighten the pieces using provided lock nut.

Repeat this process with all 4 drains.



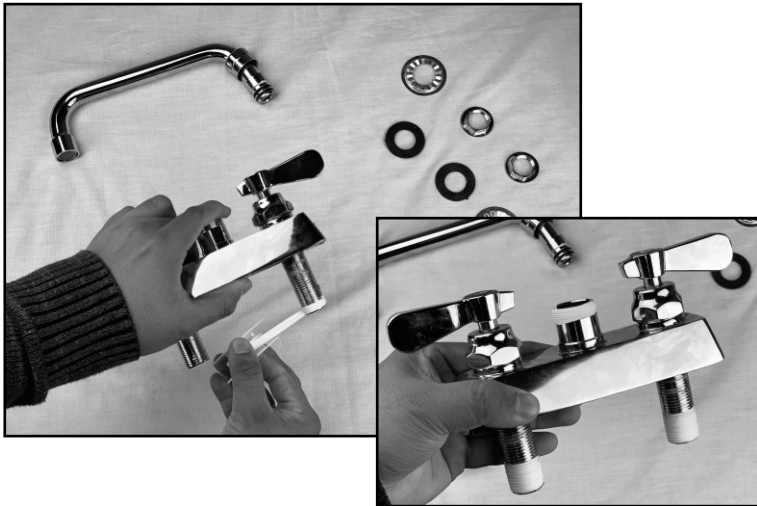

STEP 7: Cover about of 3/4" of the faucet's threads with teflon tape.

STEP 8: Install the spout using the integrated nut.



STEP 9: Place soft seal washers on both threads.

STEP 10: Install the 8" faucet on the far left basin.

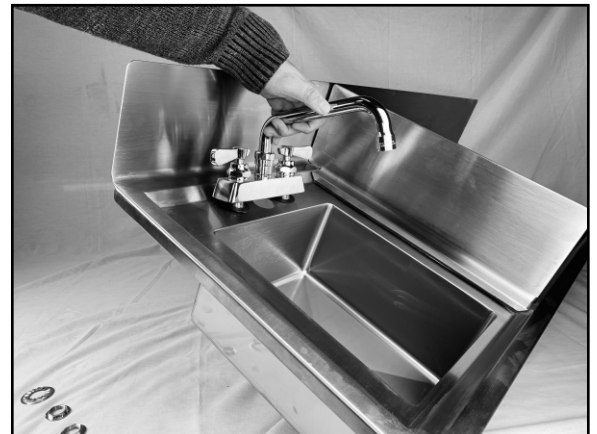



STEP 11: Place the tooth lock washer as shown in the image.

STEP 12: Use a nut to tighten the faucet.



STEP 13: Use a crescent wrench to fix the faucet in place.

STEP 14: Install 30" braided hoses on both threads.
Use a crescent wrench to tighten properly.

Note: Repeat steps 7 to 14 for the 12" faucet. Install the faucet on the far right side of the sink.





STEP 15: Cover both threads of the water heater.

STEP 16: Cover with teflon as well the pressure valve thread. Use a pipe pliers to install it as shown in the image.

Note: Please read carefully the valve's manufacturer guide prior installation.



STEP 17: Install 1/2" couplers on both threads of the water heater. Use pipe pliers to fully tighten. Cover the coupler threads with teflon tape as shown.





STEP 18: Install a splitter on each coupler.

STEP 19: Install "C" adapters on the splitters, as shown in the images. Use teflon tape on all threads and tighten all the adapters using pipe pliers.

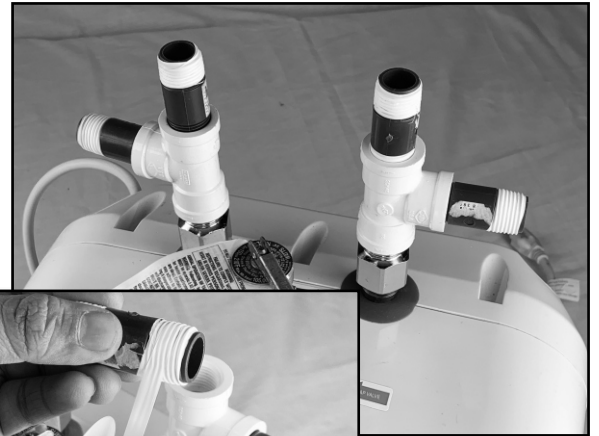

STEP 20: Install a second splitter on the cold side, and place "C" adapters on each side of the splitter, as shown on the images.



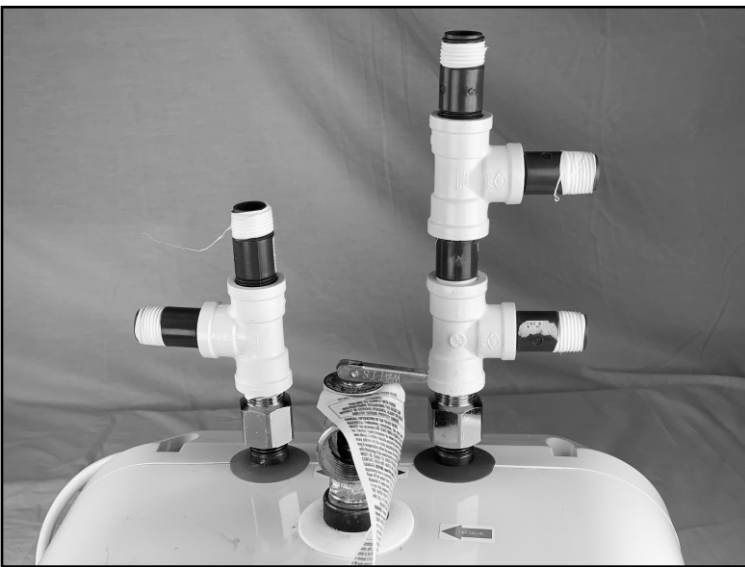

This image shows how the installation should look.

STEP 21: Place the pump on a flat surface.

Take adapters “A” and “B” and cover their threads with teflon tape.

Install adapter “A” on the left side of the pump as shown on image “3”.

Install adapter “B” on the right side.

Finish the installation by tighten both adapters with a crescent wrench.

Note: Be careful to not over tighten the adapters.

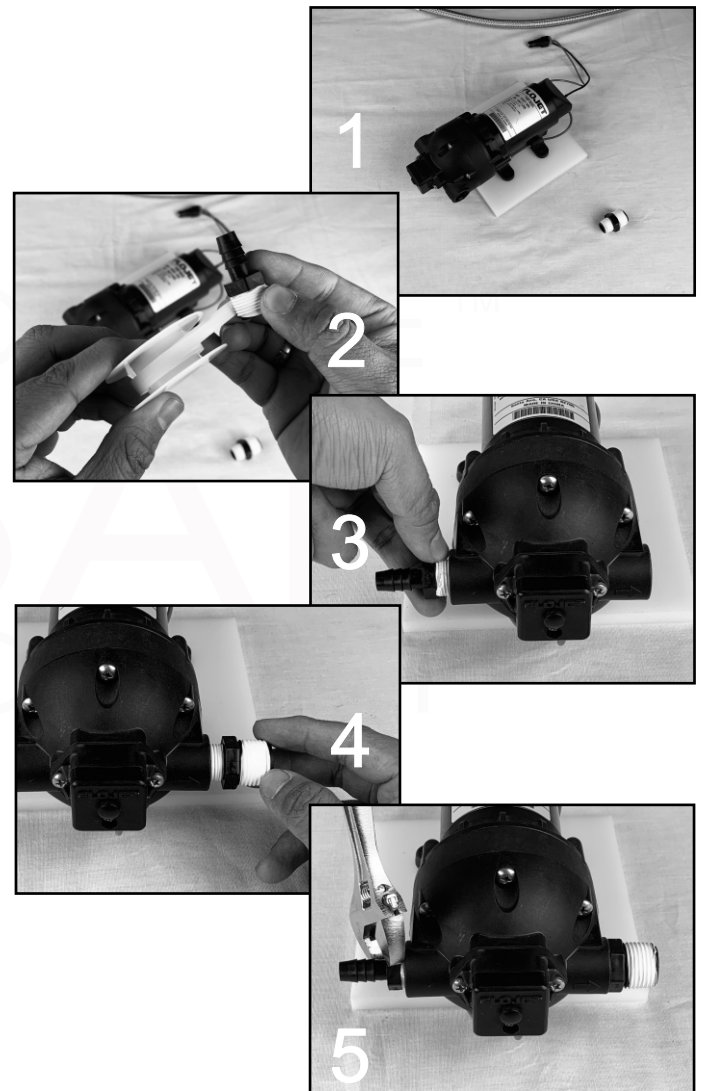

STEP 22: Insert the clear plastic hose on the left side of the pump onto adapter “A”. Put the clamp on the hose before inserting the hose as shown on the image.

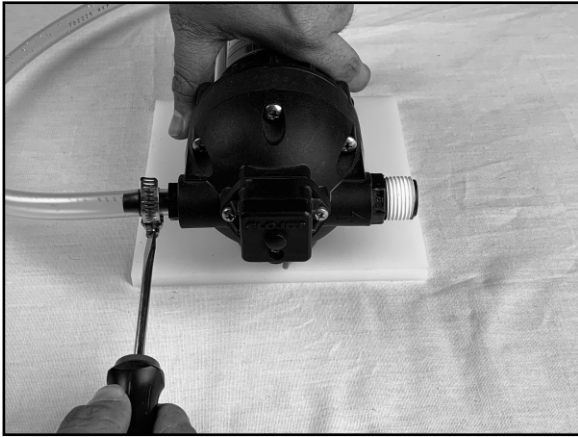

STEP 23: Tighten the hose clamps using a flat head screwdriver.

STEP 24: Install the 12" braided hose on the right side of the pump, use a crescent wrench to fix it in place.

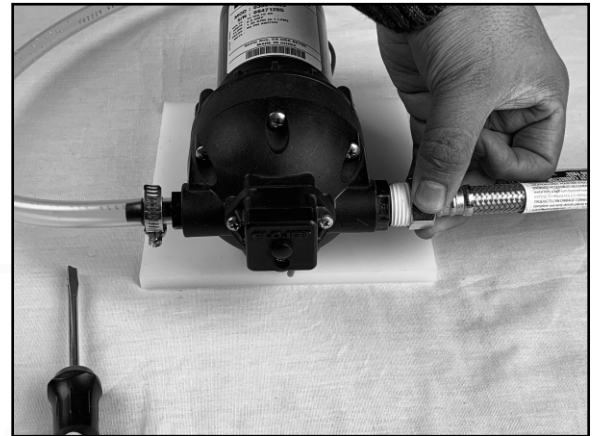

STEP 25: Place the sink on the bar assembly by aligning it with the channels on the side frames.

STEP 26: Take the PVC assembly and untighten all the upper clamps to ease the installation.



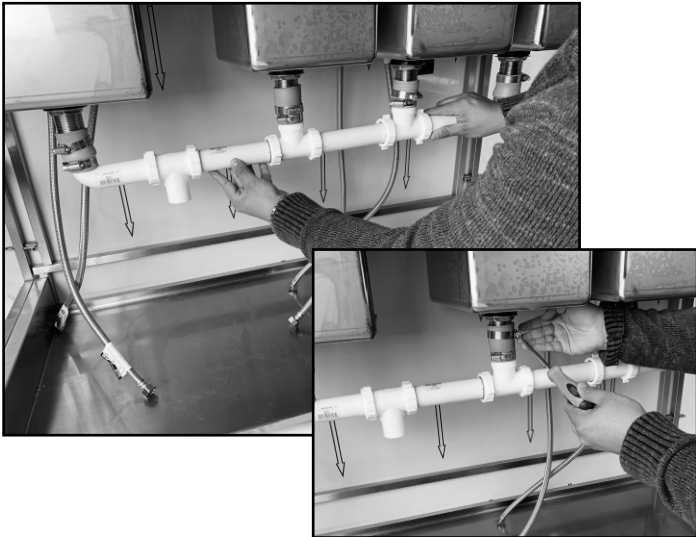

STEP 27: Align the couplers with the drains and push the PVC assembly firmly upwards.

STEP 28: Place the heater against the bottom shelf, as shown in the image.



STEP 29: Connect the braided hoses plugged to the hot sides of the faucets to the hot side connection on the heater, as shown in the image.

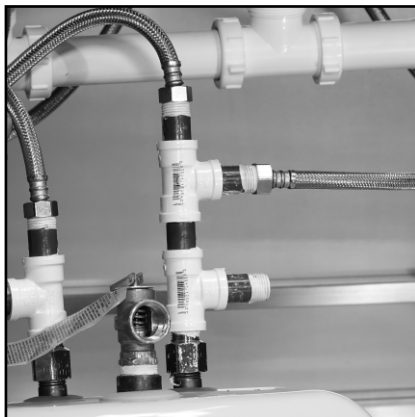

Then connect the braided hoses plugged to the hot sides of the faucets to the hot side top and top right connections on the heater, as shown in the image.

Tighten all hoses using a crescent wrench.

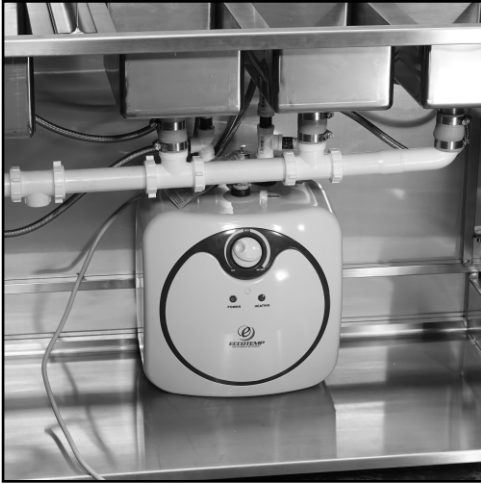

STEP 30: Pass the heater under the PVC plumbing, as shown the image.

STEP 31: Take the 5 gallon tank and place to the right side of the heater.

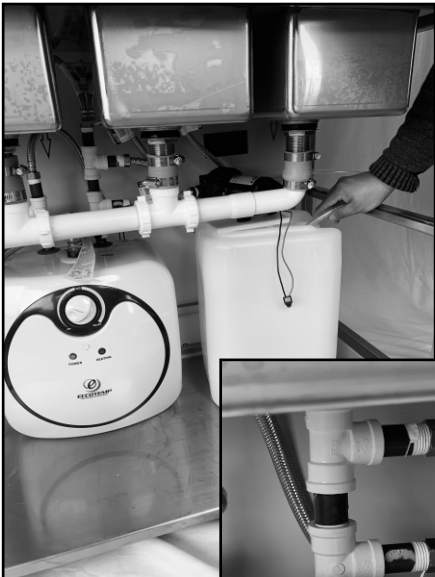

STEP 32: Place the pump on the 5 gal tank and plug the 12" braided hose from the pump to the remaining cold side "C" adapter.

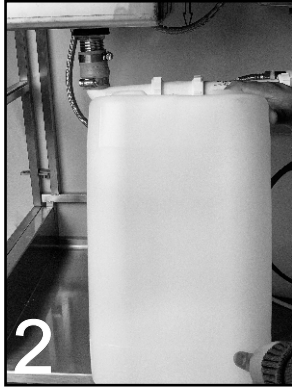

STEP 33: Place the 6 gallon tank on the left side of the heater as shown on the images.

STEP 34: Peel off the film covering the velcro stickers and stick the GFCI power strip and power adapter to the ACP panel.

Place them near the pump so you can have easy access to it.





STEP 35: Plug the power adapter to the pump and add as much electrical tape as needed, as shown on the images.

STEP 36: Plug in the heater and pump power cables to the GFCI power strip.



STEP 37: Set the upper ACP piece in place by aligning it with the posts located at the side frames.

STEP 38: To complete the setup; set the counter top to rest on the upper channels of the side frames.



Before turning the system on

- Make sure all the fittings are properly plugged and sealed.
- Double check if the hoses are plugged in the proper way.
- Verify the cables that come from the pump are connected as stated in this guide.
- Double read this guide if necessary.
- **Read the maintenance and care guide as well as the heater and pump manufacturer’s guide.**

Operating the system

To turn it on

1. Fill the clean water tank.
2. Plug the GFCI cord to a wall outlet.
3. Pump will start filling the heater, open both hot faucets and leave them open. It may take a couple of minutes to see water coming out of the faucet.
5. Once you see water coming out of both faucets, turn the faucets off.
6. Wait for 10 to 20 min for the heater to heat the water.

To turn it off

1. Unplug the GFCI cord from the wall outlet.
2. Open the faucets to release any remaining pressure inside the hoses and heater.
3. Drain the gray water tank. To take it off of the shelf you shall follow the setup guide steps in reverse order.
4. The heater will still have water inside of it after turning the system off. You can leave the water inside for the next use or drain it. To pour water out tip the heater over to let it drain from the top.

Recommendations

- Keep in mind that the heater has a 2.5 Gal tank inside of it and the clean water tank is 5 Gal. Pay attention to the gray water tank, it could overflow.
- Adjust the temperature of the water with the temperature knob on the water heater.
- The pump is capable of running dry for a couple minutes. Serious damage could occur if it runs dry for long periods of time.

CAUTION: The maximum temperature the heater can reach is 140F, using the water at this temperature could cause severe burns. Failure to install the pressure relief valve may result in injury or property lost. The Portable Bar Company IS NOT liable for any injury caused by misuse, spills, accidents nor by improper installations, alterations, or repairs. Please use the system with caution only.



Contact us

Tel # 877-958-7901

Fax # 866-659-3353

E-mail: info@theportablebarcompany.com

Visit us at

www.theportablebarcompany.com

