

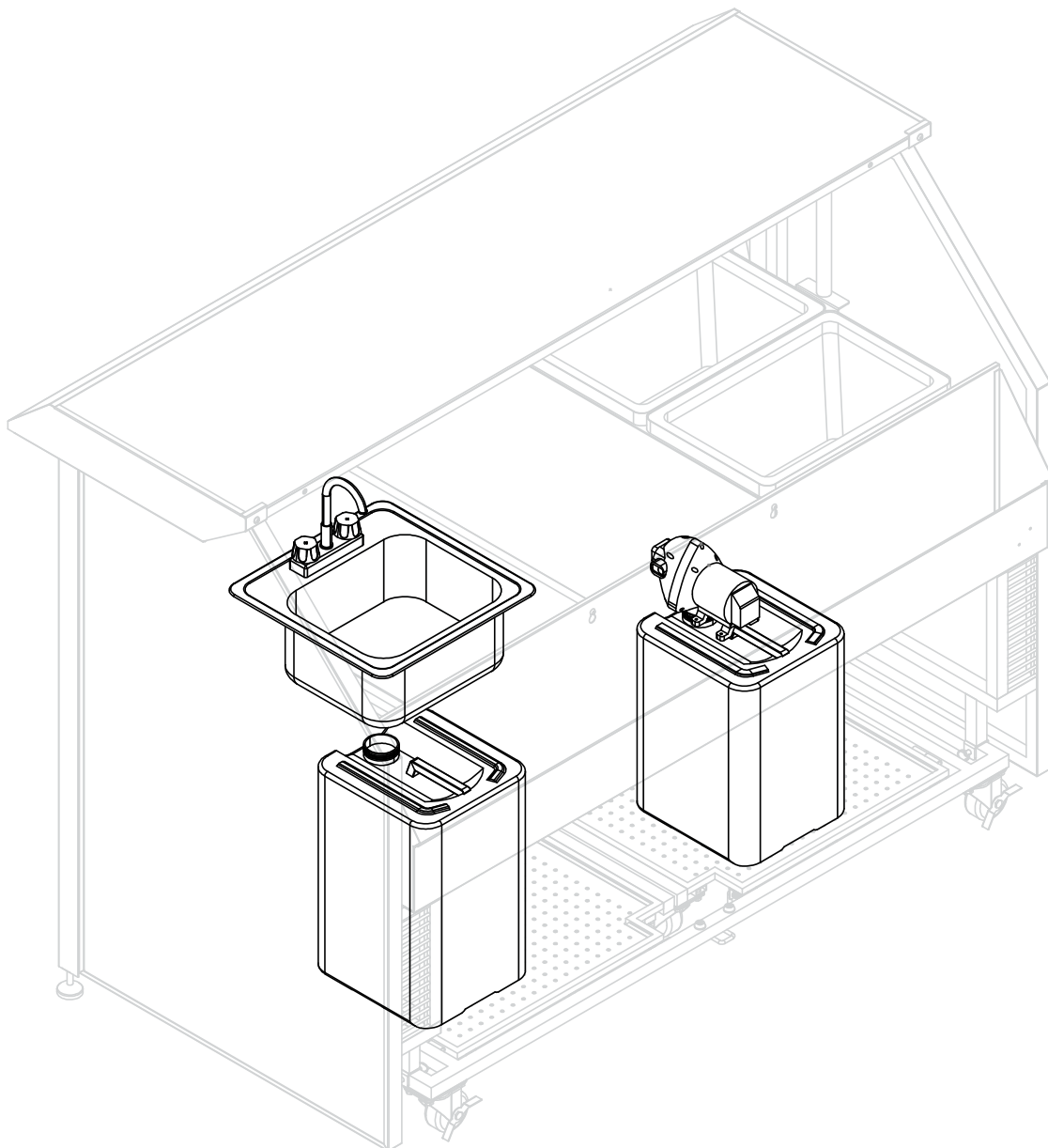

# PROFESSIONAL BAR SELF CONTAINED SINK SYSTEM



- **Read all the instructions before installing.**
- **Remove all packing materials before you start.**
- **This installation requires basic mechanical skills.**
- **Proper installation is the responsibility of the installer.**
- **Product failure due to improper installation is not covered under the warranty.**
- **Keep this instruction manual.**



Faucet  
QTY: 1

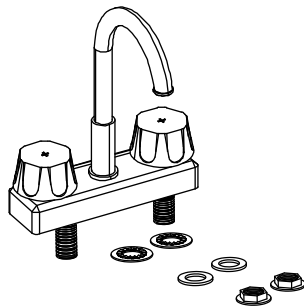

Sink  
QTY: 1

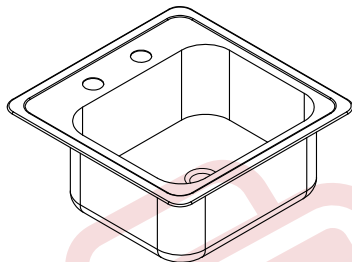

Stainless Steel Sink Insert  
QTY: 1

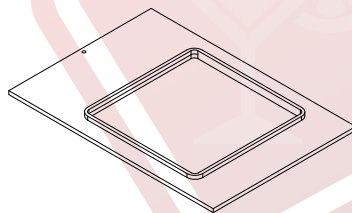

Drainer and tailpiece  
QTY: 1ea

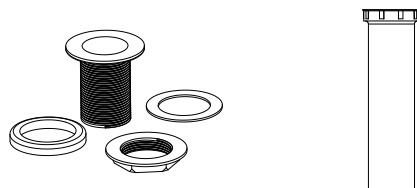

Water Tanks  
QTY: 1ea

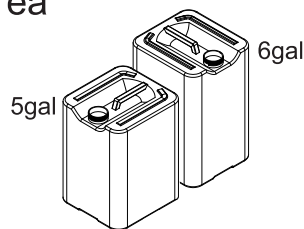

Pump  
QTY: 1

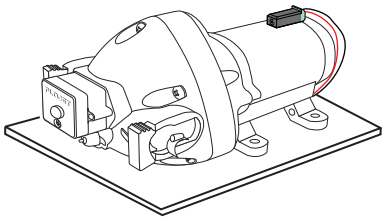

Surge protector and Power adapter  
QTY: 1 ea

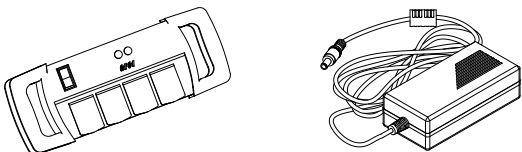

Plastic hose and clamp  
QTY: 1 ea



Braided Hoses  
QTY: 3

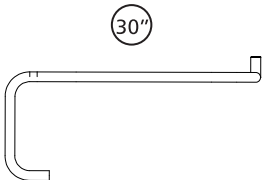

Adapters  
QTY: 6

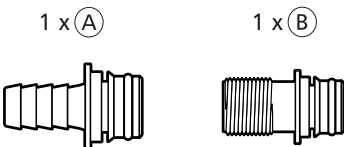

*Note: Parts are not to scale.*

**STEP 1:** Remove speed rail and counter. Remove counter by releasing spring latches and lifting counter up.

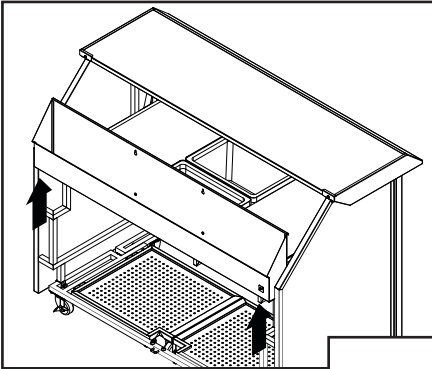

Figure 1

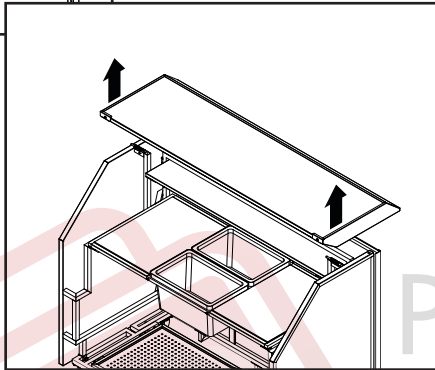

Figure 2

**STEP 2:** Set basin on a flat surface. Install faucet following the pictures below.

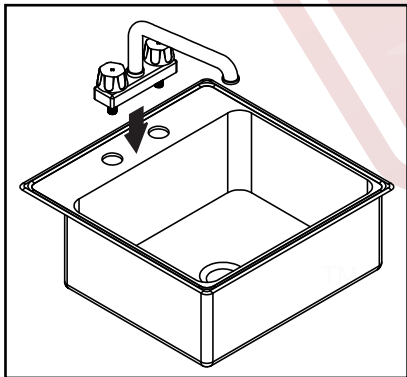

Figure 3

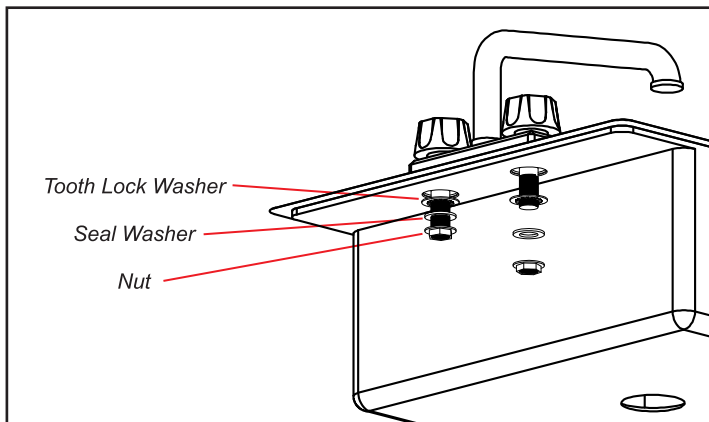

Figure 4

**STEP 3:** Install sink drainer by placing it and its seal washer as shown below. Follow diagram below to complete drainer installation. Proceed then to install drainer tailpiece.

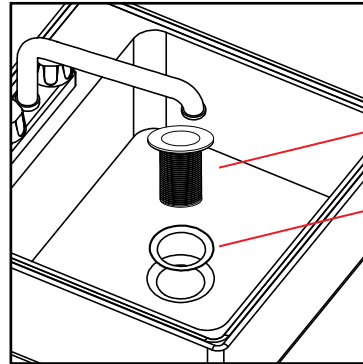

Figure 5

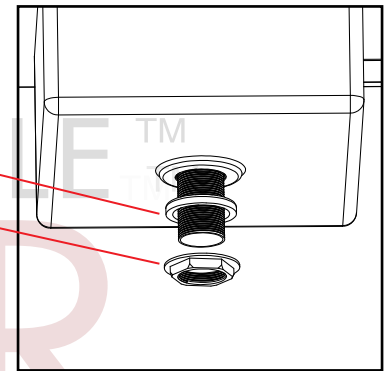

Figure 6

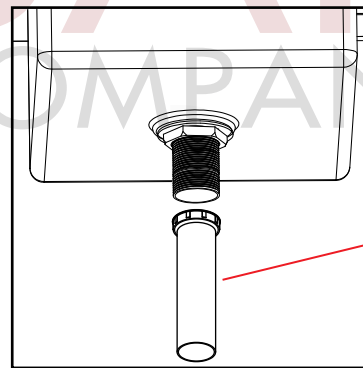

Figure 7

**STEP 4:** Connect the 30" braided hose to the cold side of the faucet and plug a cap on the other side. Use as much teflon tape as needed.

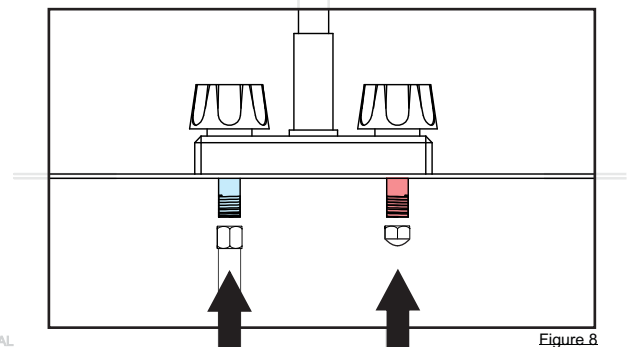

Figure 8

**STEP 5:** Insert sink's working surface on either side of the bar. Secure working surface using provided thumbscrew. Install sink as shown below.

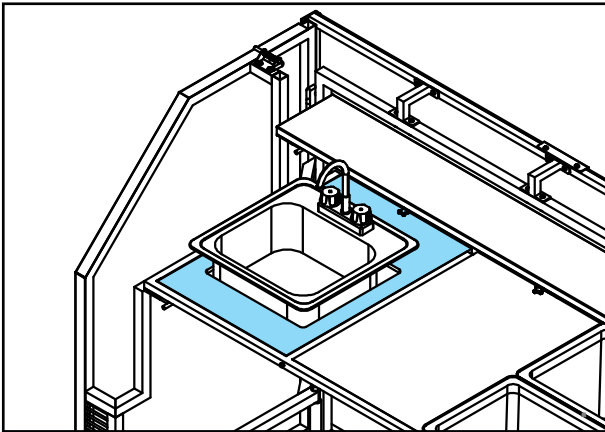

Figure 9

**STEP 6:** Slide in gray water tank and align sink's drainer piece with the opening at the top of the tank. Make sure to leave strain tailpiece inside the tank's opening. Slightly lift sink assembly if necessary.

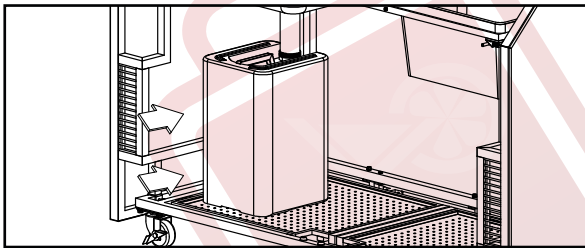

Figure 10

**STEP 7:** Install adapter (A) to the inlet port of the pump; first push the adapter into the pump, then fix the adapter in place by pushing the mounted blue clamp; as shown below. Use as much teflon tape as needed.

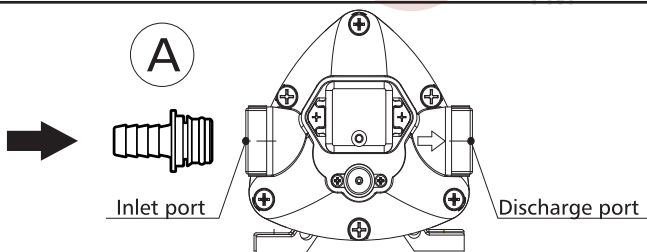

Figure 11

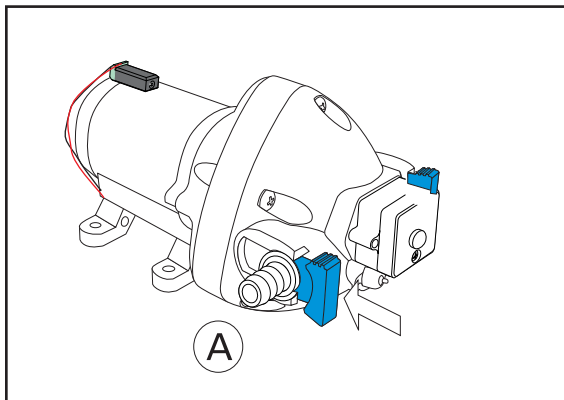

Figure 12

**STEP 8:** Install the plastic hose in the pump's inlet port using a hose clamp.

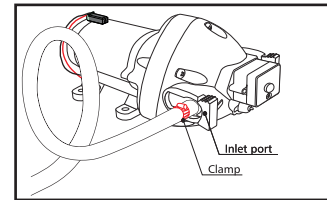

Figure 13

**STEP 9:** Slide in clean water tank. Place pump on top and insert the clear plastic hose in the tank's opening.

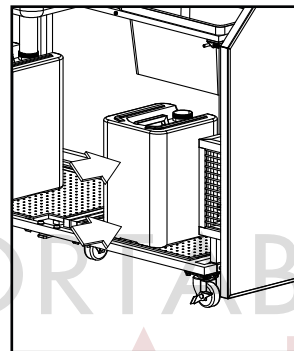

Figure 14

1

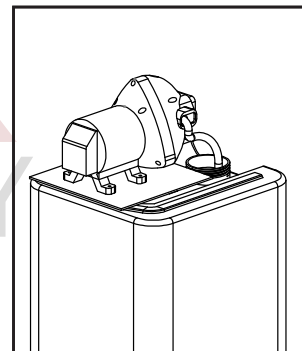

Figure 15

**STEP 10:** Place surge protector on the shelf above the sink. As shown below.

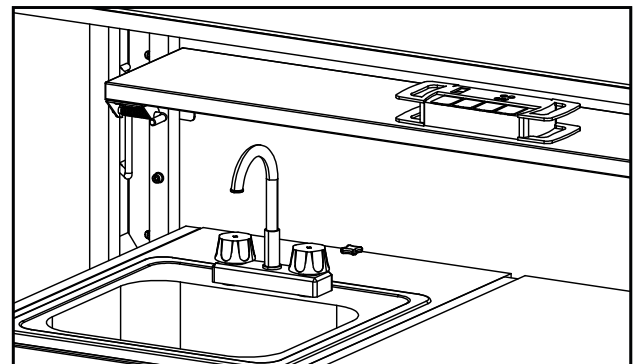

Figure 16

**STEP 11:** Take hose plugged to faucet and install it to pump's discharge port, as shown below:

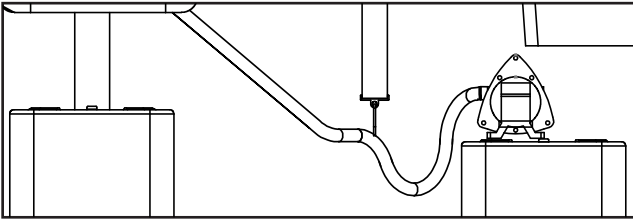

Figure 17

**STEP 12:** Plug the pump's power adapter cable to the plug placed on the pump.

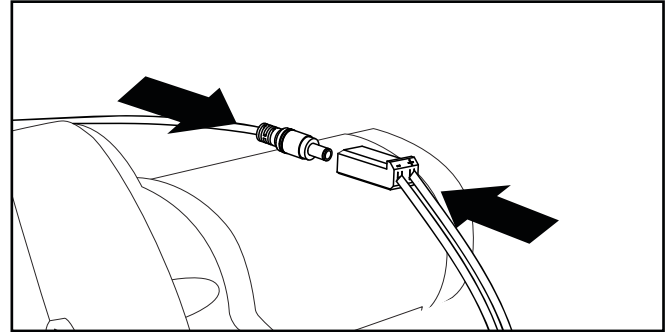

Figure 18

**STEP 13:** Plug heater and pump's power adapter to surge protector.

**Do not plug the power supply to the wall or battery yet.  
Pump is active when plugged in.  
There's no on/off switch.**

## Before turning the system on

- Make sure all the fittings, hoses and cables are properly plugged and/or sealed.
- Double read this guide if necessary.
- Read the maintenance and care guide as well as the pump manufacturer's guide.

## Operating the system

### To turn it on

1. Fill the clean water tank.
2. Open the faucet.
3. Connect the pump to a wall plug or battery.
3. The pump will start working, once you see water coming out of the faucet close the faucet.

### To turn it off

1. Open the faucet.
2. Disconnect the pump from the wall plug

### Recommendations

- Always keep water inside the the clean water tank, this is critical for the system to work properly.
- The hoses could keep water inside of them after every use.
- The pump is capable of running dry for a couple minutes. Serious damage could occur if it runs dry for long periods of time.
- When disassembling the system there will always be water left in the hoses. Have a towel handy as you are taking apart.

**CAUTION:**The Portable Bar Company IS NOT liable for any injury caused by misuse, spills, accidents nor by improper installations, alterations, or repairs. Please use the system with caution only.



**Contact us**

**Tel #** 877-958-7901

**Fax #** 866-659-3353

**E-mail:** [info@theportablebarcompany.com](mailto:info@theportablebarcompany.com)

**Visit us at**

**[www.theportablebarcompany.com](http://www.theportablebarcompany.com)**

