

## Self Contained Sink System

Hot & Room temp. water

ALL DIMENSIONS ARE IN INCHES. THE INFORMATION CONTAINED WITHIN THIS DOCUMENT IS THE SOLE PROPERTY OF THE PORTABLE BAR COMPANY. ANY REPRODUCTION IN PART OR AS A WHOLE WITHOUT THE WRITTEN PERMISSION OF THE PORTABLE BAR COMPANY IS PROHIBITED.

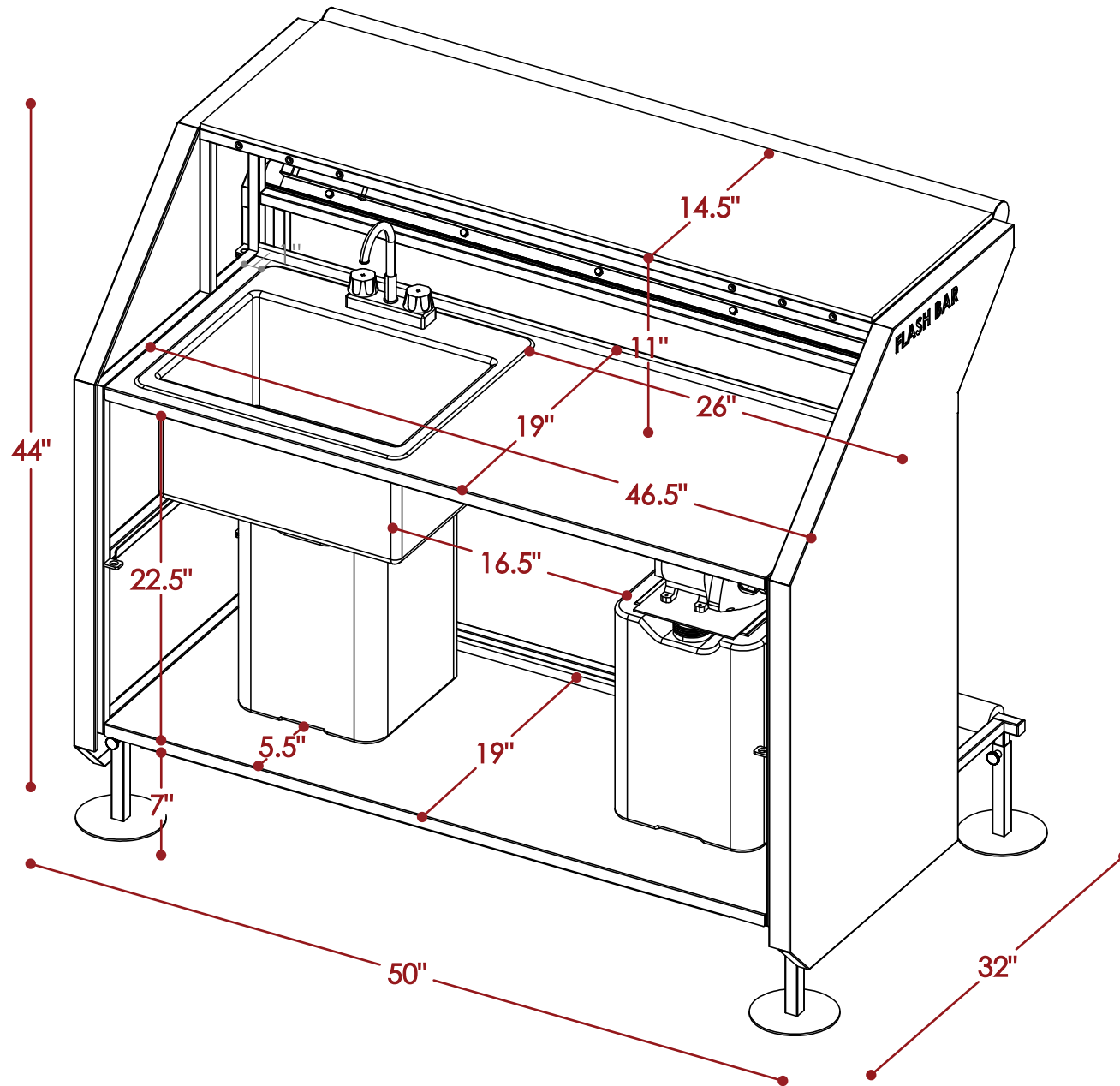

## Self Contained Sink System

Room temperature water

ALL DIMENSIONS ARE IN INCHES. THE INFORMATION CONTAINED WITHIN THIS DOCUMENT IS THE SOLE PROPERTY OF THE PORTABLE BAR COMPANY. ANY REPRODUCTION IN PART OR AS A WHOLE WITHOUT THE WRITTEN PERMISSION OF THE PORTABLE BAR COMPANY IS PROHIBITED.

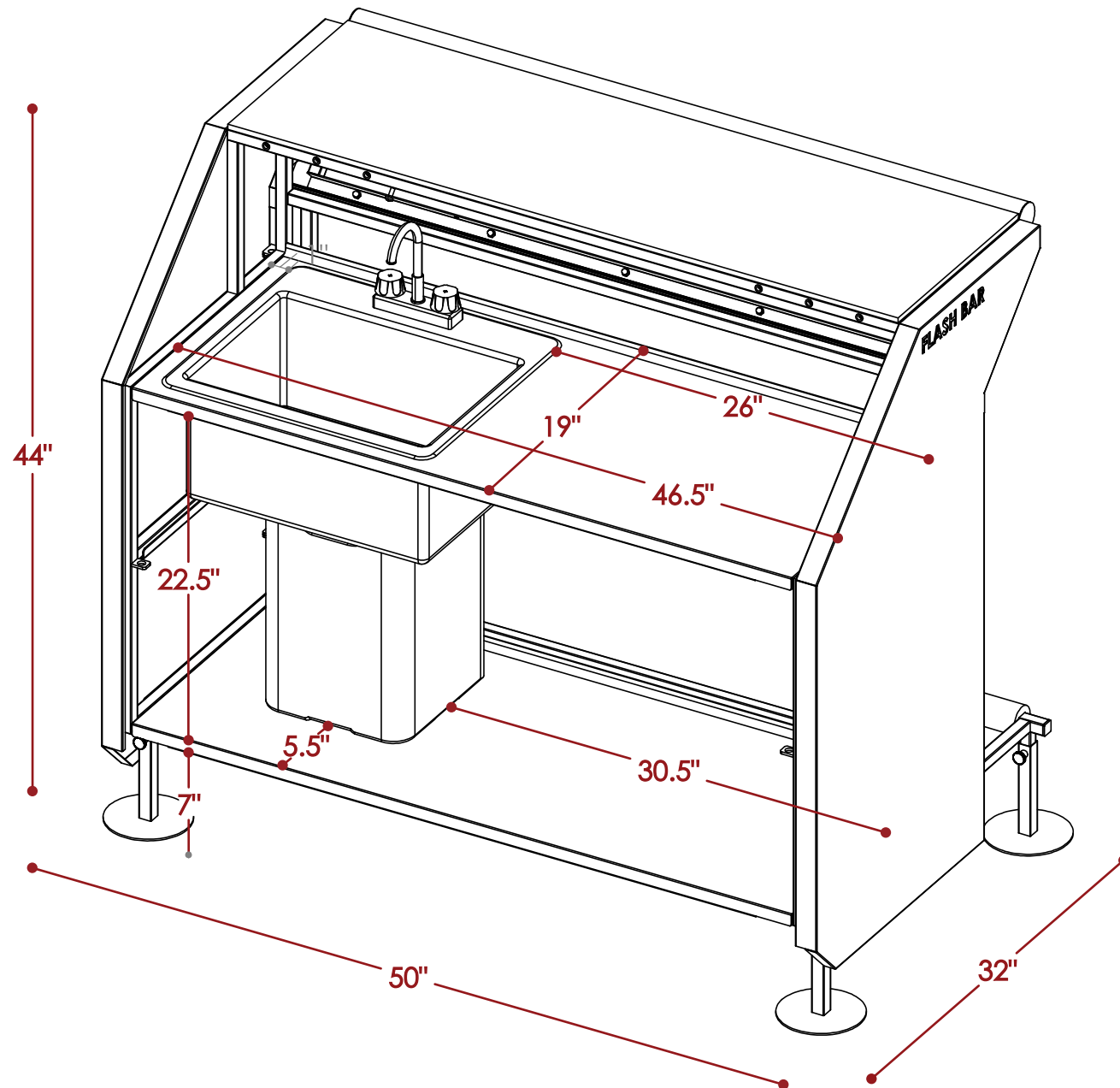

## Grey Water Sink

ALL DIMENSIONS ARE IN INCHES. THE INFORMATION CONTAINED WITHIN THIS DOCUMENT IS THE SOLE PROPERTY OF THE PORTABLE BAR COMPANY. ANY REPRODUCTION IN PART OR AS A WHOLE WITHOUT THE WRITTEN PERMISSION OF THE PORTABLE BAR COMPANY IS PROHIBITED.

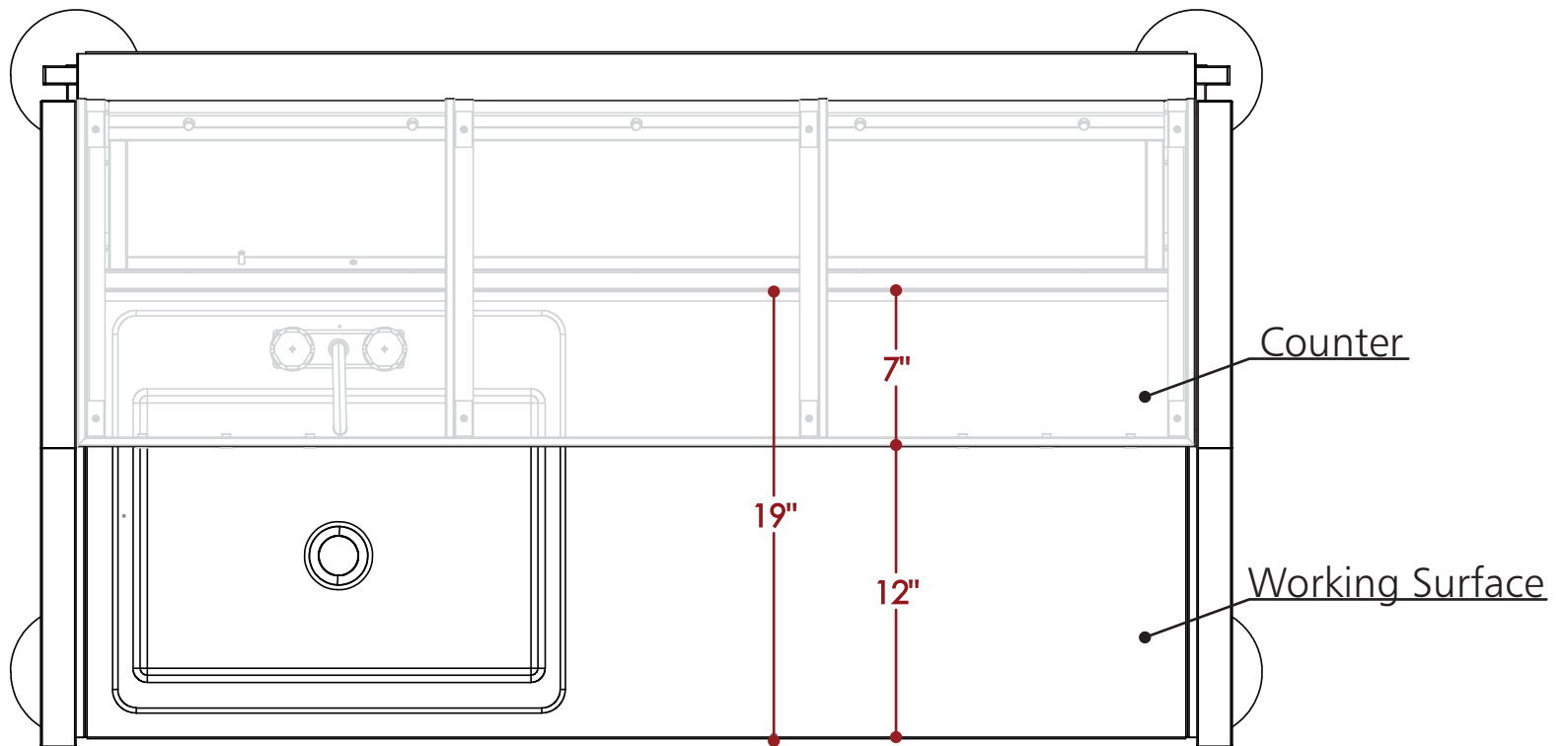

ALL DIMENSIONS ARE IN INCHES. THE INFORMATION CONTAINED WITHIN THIS DOCUMENT IS THE SOLE PROPERTY OF THE PORTABLE BAR COMPANY.  
ANY REPRODUCTION IN PART OR AS A WHOLE WITHOUT THE WRITTEN PERMISSION OF THE PORTABLE BAR COMPANY IS PROHIBITED.

Sink

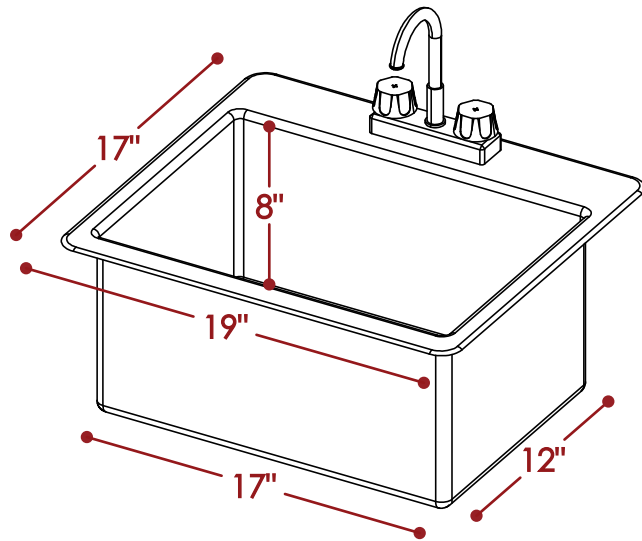

2.5gal Water Heater

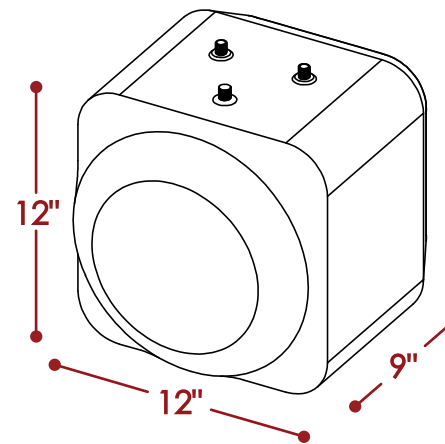

5gal Gray Water Tank

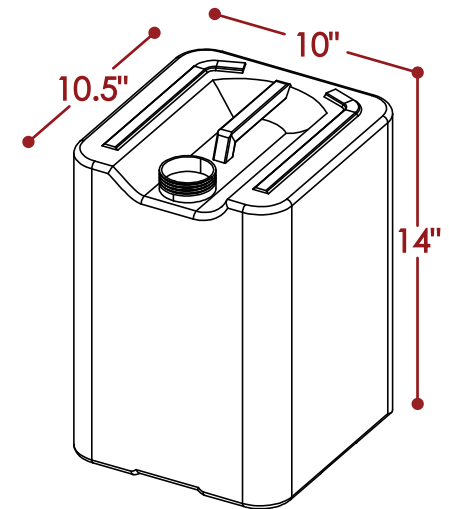

2gpm Water Pump

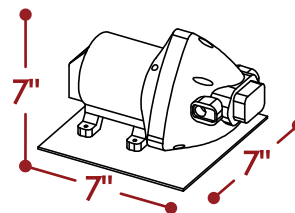

## Sink Components

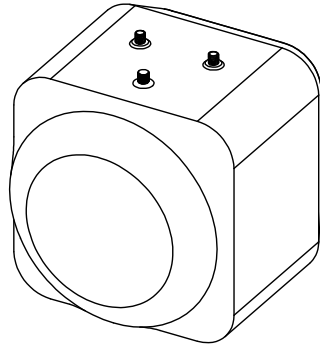

## Water Heater

Eccotemp EM.25 Heater

Voltage: 110-120 VAC

Amperage: 12A

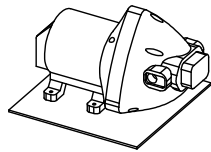

## Water Pump

Jabsco Par-Max Series Pump

Voltage: 12 VDC

Amperage: 6A



For more information visit: <https://theportablebarcompany.com/wp-content/uploads/2024/02/SINK-Heater-Instruction-Manual.pdf>



## Power Requirements